

All About Reception

Meet your Reception team for September 2023





Meet the staff

- **Miss Noble**
Cherry Class Teacher and Year Group Leader
- **Mrs Patten**
Fir Class Teacher
- **Mrs Keshtmand**
Maple Class Teacher
- **Mrs Jones**
Cherry and Fir Class Teacher
- **Mrs Newson, Mrs Meta, Mrs Amin and Mrs Astbury**
Reception Teaching Assistants



Uniform and school bags

Please refer to the uniform policy and remember that:

- ❑ **No jewellery** should be worn
apart from a plain watch and small stud earrings
- ❑ **Plain black, velcro schoolshoes**
(no boots or sport shoes) & school socks
- ❑ **Long hair** should be **tied up**
no hair accessories or shaved patterns
- ❑ **PE kit** worn to school on your
child's PE day - Monday
- ❑ **Chase Bridge Book Bag**
these are needed daily



Preparing for September

Get to know our units of work and learning expectations -
All curriculum details are available on the website:

<https://www.chasebridge.richmond.sch.uk/our-classes/eyfs>

Read our Online Safety overview - and discuss with your child
(age appropriate)

<https://www.chasebridge.richmond.sch.uk/online-safety>



Start of the day

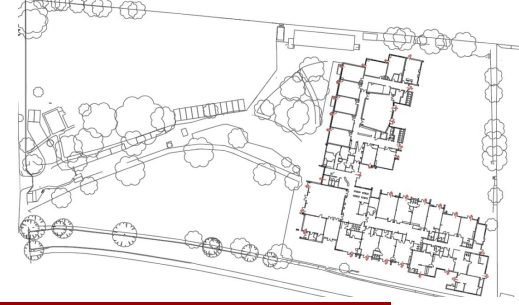

- ☐ Children will start school at 8.45am
- ☐ Children will line up with their class teacher in the hall.
- ☐ Parents will stay close to the field and children will walk towards their class teacher to line up.
- ☐ To avoid congestion, we ask that you please leave the school site as soon as your child is with their teacher.

It is important to arrive promptly to school to help the children have a settled start to their day.



End of the day

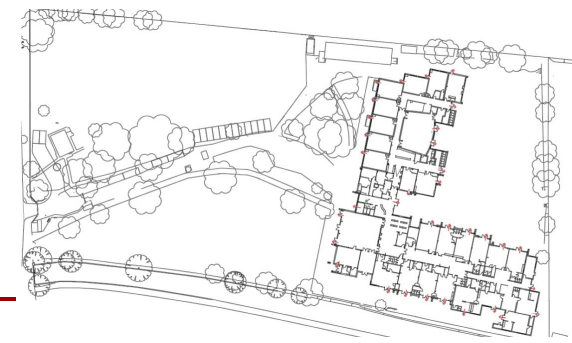

- ☐ Children will finish school at 3.15pm.
- ☐ Children to be collected from the terrace.
- ☐ Parents will wait close to the field and the teacher will dismiss the children to parents.
- ☐ The playground and fields will not be in use after school. As pick up points are used for different year groups at their end of day time, all parents are expected to leave the school site as quickly as possible to ensure a safe and calm environment.



Being prepared

☐ A water bottle



☐ A weather appropriate jacket

☐ Bookbag

☐ Sunhat/suncream

☐ Hats/scarves/gloves

Please can every child also donate a tissue box to the school at the start of term.



Our Reception topics

All our curriculum details are available on the website:

<https://www.chasebridge.richmond.sch.uk/our-classes/eyfs>

Marvellous Me
Rules and routines and settling in

Growing and Changing
Growing plants
Scientific experiments

Reach for the Stars!
A study on space

Our Wonderful World
Maps
Comparing our local area to different locations

Once Upon a Time
Focusing on traditional tales and growing

Kings, Queens and Castles
Monarchs - past and present



The year ahead



- Stay and Play 11.7.23 or 13.7.23
- Staggered starts and part time hours weeks commencing 4.9.23 and 11.9.23
- Reception Baseline
A 1:1 assessment of the children to help monitor their progress throughout their time at Chase Bridge
- Curriculum based workshops
- Christmas performance
- Reading/Little Wandle Information Workshop for Parents
- Trips to the high street and Bocketts Farm
- Sports Day



Reception Gallery



Home-school links

Tapestry is our primary platform for keeping in regular contact with you about your child's learning. If you haven't connected yet, please contact the office where they will be happy to send an invite request.

We will use Tapestry to:

- ☐ set weekly learning tasks for children that focus on reinforcing learning from the week, extending learning further, and/or previewing upcoming learning
- ☐ enhance the learning at school
- ☐ provide helpful announcements/reminders to families and children
- ☐ inform families of the weekly learning and how they can support
- ☐ celebrate awards and achievements
- ☐ build a strong partnership between home and school

*Tapestry should **not** be used to send messages **regarding incidents at school, concerns to raise, medical needs or absence requests**. Messages are checked **once a week** and are used primarily for the teacher to contact parents to share learning celebrations and expectations; please email the info account if you wish to contact the teacher about any of the above.*



Home-learning



At Chase Bridge, we believe in setting meaningful and purposeful home-learning opportunities that helps children to consolidate the core skills they have learnt at school.

Reception weekly expectations:

- ☐ **Reading** - minimum of 10 minutes a day
- ☐ **Homework** - uploaded on Tapestry weekly



How you can help in school

Can you ...

- ☐ Help in class?
- ☐ Listen to readers?
- ☐ Volunteer in our library?
- ☐ Help on a school trip?
- ☐ Share your expertise with the children?
- ☐ Be a mystery reader?

Please make sure you talk to your class rep. and/or teachers and attend one of our **new helper induction sessions.**



See you in September!

