

All About Reception

Meet your new **Reception** team for September 2026



Progress over the year

Academic

Key focus: phonics

Social

Key focus: being a good friend

Emotional

Key focus: managing emotions



Vision and Values

Excel At Learning



practice makes progress
resilience curiosity

Care For Others



responsibility
compassion respect

Express Your Talents



self-belief
enthusiasm courage

Learning is not just about facts; it's about developing qualities and characteristics.
We reinforce our vision and 9 values in lessons and assemblies.
Please support with this at home.



Ofsted - outstanding in all areas

- Quality of Education - Outstanding
- **Early Years - Outstanding**
- Behaviour and Attitudes - Outstanding
- Personal Development - Outstanding
- Leadership and Management - Outstanding



Meet the staff

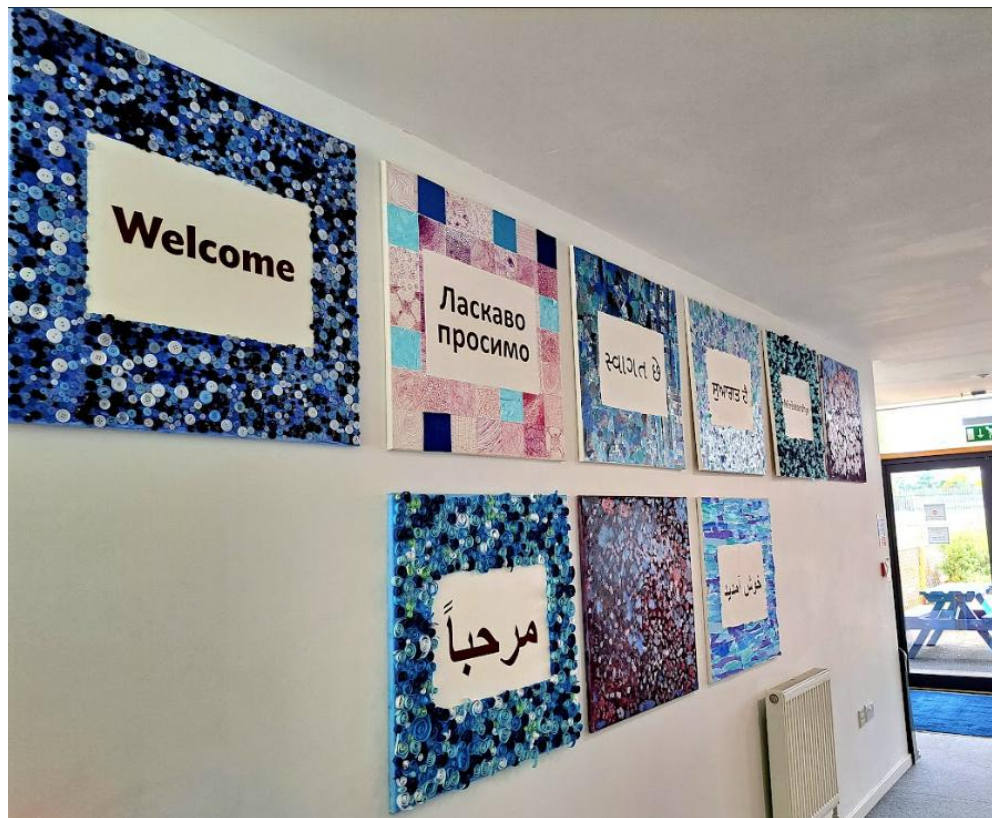

- ? **Miss Noble**
Cherry Class Teacher and Year Group Leader
- ? **Miss Watson**
Fir Class Teacher
- ? **Miss Crow**
Maple Class Teacher
- ? **Teaching Assistants**
Work across the phase
- ? **Friends of Chase Bridge**
– class rep
to be announced!



School readiness



- ❓ Growing independence
 - ❓ Building relationships and communicating
 - ❓ Physical development
 - ❓ Healthy routines
-
- ❓ All of the children are on their own, unique journey



Holiday 'get ready' list

Here are some suggestions of ways to help your child transition to starting Reception in September.

Practise taking jumpers, coats and shoes on and off.

Recognising their name.

Talking positively about school.

Toilet training and washing hands.

Choose it, use it and put it away.



Uniform and school bags

Please refer to the uniform policy and remember that:

- ❑ **No jewellery** should be worn
apart from a plain watch and small stud earrings
- ❑ **Plain black velcro school shoes**
(no boots or sport shoes) & school socks
- ❑ **Long hair should be tied up**
no fussy hair accessories or shaved patterns
- ❑ **Weather appropriate coat**
- ❑ **PE kit** worn to school on your child's PE day -
Monday
- ❑ **Chase Bridge book bag and water bottles**



Start of the day

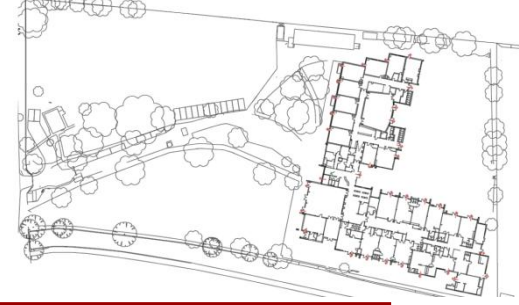

- ❑ Children will start school at 8.50am.
- ❑ Children will line up with their class teacher in the Chase Hall.
- ❑ Parents will stay on the terrace and children will walk into the hall to their class teacher to line up.
- ❑ To avoid congestion, we ask that you please leave the school site as soon as your child is with their class teacher.



Expectations

BE
READY



BE
RESPECTFUL

BE
SAFE



Ready: looking at my teacher; listening carefully; sitting nicely

Respectful: helping others; using kind words; sharing and waiting my turn

Safe: kind hands; walking sensibly; tidying up toys



End of the day

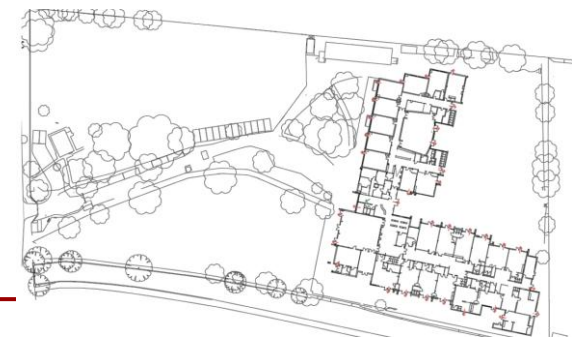

- ❑ Children will finish school at 3.20pm.
- ❑ Children will be dismissed from the Chase Hall.
- ❑ Parents will wait on the terrace area and the teacher will dismiss the children to parents. Anyone collecting must be on your Arbor account.



Lunches and snack time

You must select your child's lunches on Arbor. This will need to be done termly so you are selecting from the correct menu.

Please look at the lunch menu and discuss the options with your child.

<https://www.chasebridge.richmond.sch.uk/school-life/useful-information/school-lunches>

Your child will be offered milk and school fruit daily. You do have the option of bringing your own nut-free, healthy snack if you would prefer.



Our Reception topics

All our curriculum details are available on the website:
<https://www.chasebridge.richmond.sch.uk/our-classes/eyfs>

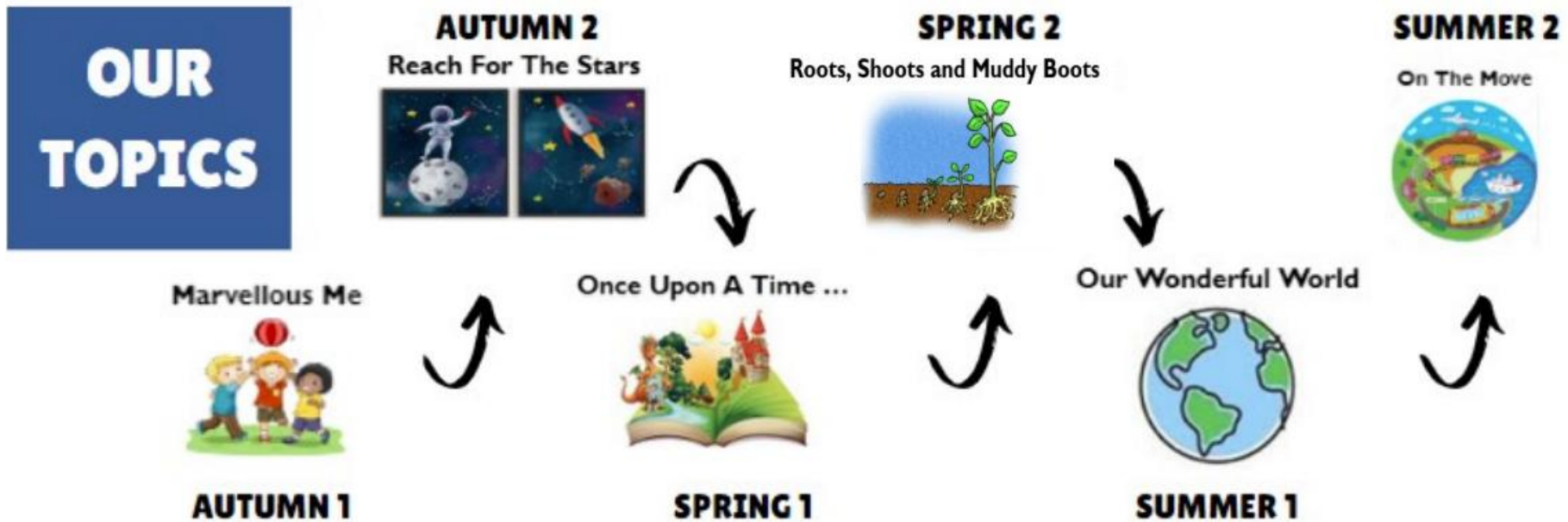

Home-school links

Tapestry is our primary platform for keeping in regular contact with you about your child's learning. Please activate your account when you are sent an email in September and ensure you have given permission on Arbor.

We will use Tapestry to:

- ❓ enhance the learning at school
- ❓ provide helpful announcements/reminders to families and children
- ❓ celebrate awards and achievements
- ❓ build a strong partnership between home and school



How you can help in school

Can you ...

- ❑ Help in class?
- ❑ Listen to readers?
- ❑ Volunteer in our library?
- ❑ Help on a school trip?
- ❑ Share your expertise with the children?
- ❑ Be a mystery reader?

Please make sure you talk to your class rep. and/or teachers and attend one of our **new helper induction sessions.**



Transition

- ❑ **Stay and Play - Tuesday 7th and Thursday 9th July 3:30pm - 4:00pm**
- ❑ **Home Visits for families new to Chase Bridge - Wednesday 2nd – Friday 4th September**
- ❑ **School Visits for children at Chase Bridge Nursery - Wednesday 2nd – Friday 4th September**
- ❑ **Monday 7th September - Thursday 10th September:** children will be allocated a morning or afternoon session for 4 days.
- ❑ **Friday 11th September onwards:** all children will be at school for their full-time hours and they will begin having lunch at school.
- ❑ **Friday 11th September PM:** To celebrate the children's first day, you are invited to come and join them for a picnic from 2pm where you will have the opportunity to get to know other Chase Bridge families.



Any questions?

Video: Day In The Life

[Welcome to Reception - Chase Bridge Primary School](#)

Packs - school menu, school milk, uniform, information for starting, how to encourage independence, Starting Reception booklet and "This Is Me" book

