

# All About Year 1

Meet your new Year 1 team for September 2022





# Meet the staff

---

- Mrs Demetriou  
Willow class teacher and year group leader
- Miss Brown  
Oak class teacher
- Miss Wilkins  
Apple class teacher
  
- Nursery/Reception/Year 1 Teaching Assistants



Mrs Meta   Miss Rush   Mrs Amin   Mrs Pyke   Mrs Elshenawry

- Friends of Chase Bridge – class rep



# Uniform and school bags

Please refer to the uniform policy and remember that:

- ❑ **No jewellery** should be worn apart from a plain watch and small stud earrings
- ❑ **Plain black school shoes** (no boots or sport shoes) & school socks
- ❑ **Long hair** should be **tied up** no fussy hair accessories or shaved patterns
- ❑ **PE kit** worn to school on your child's PE day - Wednesday
- ❑ **Bags** plain, compact/sensible small size





# Start of the day

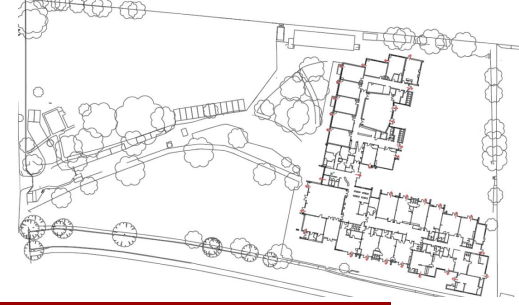

- ☐ Children will start school at 8.45am
- ☐ Children will line up with their class teacher in the playground.
- ☐ Parents will stay behind the red line and children will walk towards their class teacher to line up.
- ☐ To avoid congestion, we ask that you please leave the school site as soon as your child is with their class teacher.





# End of the day

---

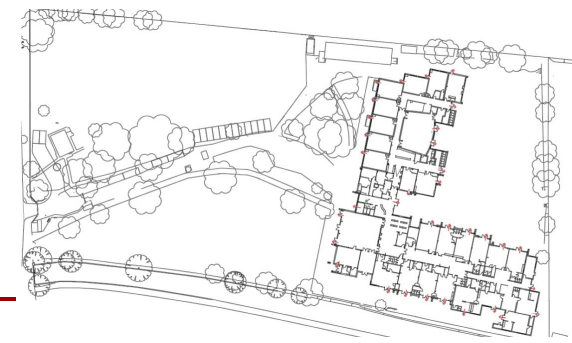

- ☐ Children will finish school at 3.15pm
- ☐ Children to be collected from the playground
- ☐ Parents will wait behind the red line and the teacher will dismiss the children to parents.
- ☐ The playground will not be in use after school. As pick up points are used for different year groups at their end of day time, all parents are expected to leave the school site as quickly as possible to ensure a safe and calm environment.



# Being prepared

---

- ☐ A water bottle 

A small pencil case containing ...

- ☐ a pencil,
- ☐ pencil sharpener,
- ☐ rubber,
- ☐ glue stick,
- ☐ high-lighter pens,
- ☐ colouring pens and pencils



# Our Year 1 topics

---

All year 1 curriculum details are available on the website:

<https://www.chasebridge.richmond.sch.uk/our-classes/year-1>

**Henry VIII:**  
Henry VIII and  
Hampton  
Court Palace

**Old Toys New  
Toys:** materials  
and their  
properties

**Who do you  
think you are?:**  
using our five sense  
to learn about the  
world

**Plant  
Detectives:** wild  
and garden  
plants and  
deciduous and  
evergreen plants

**Wonderful  
Weather:**  
changes across  
the 4 seasons

**The Animal  
World:** birds,  
mammals, fish,  
reptiles and  
amphibians





# Year Group Overviews

This is an outline all the broad areas of learning by term for the foundation subjects; it gives an overview of all the national curriculum objectives for the year for English and maths, and shows the class texts used to draw upon for their writing. This will be uploaded to the website soon.



# The year ahead

---



- Curriculum based trips  
Hampton Court Palace, Chertsey Museum Toy Workshop, Kew Gardens, Weather Drama Workshop & Church Visit.
- Phonics Screening Check in June 2023
- Year 1 Assembly & Christmas performance
- Phonics/Little Wandle Information Workshop for Parents
- Sports Day



# Year 1 Gallery

---

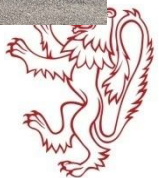



# Home-learning

---



At Chase Bridge, we believe in setting meaningful and purposeful home-learning opportunities that helps children to consolidate the core skills they have learnt at school.

Year 1 weekly expectations:

- ☐ **Reading** - minimum of 10 minutes a day
- ☐ **Maths Shed** - set bi-weekly
- ☐ **Spelling Shed** - set once a week + a weekly spelling test (from November 2022)
- ☐ **Seesaw** - set bi-weekly to consolidate, revisit or preview core learning linked with a broad range of curriculum subjects.



# Home-school links



Seesaw is our primary platform for keeping in regular contact with you about your child's learning. If you haven't connected yet, please contact the office where they will be happy to send an invite request.

## **We will use Seesaw to:**

- ☐ set bi-weekly learning tasks for children in Year 1 that focus on reinforcing learning from the week, extending learning further, and/or previewing upcoming learning
- ☐ enhance the learning at school
- ☐ provide helpful announcements/reminders to families and children
- ☐ inform families of the weekly learning and how they can support
- ☐ celebrate awards and achievements
- ☐ Build a strong partnership between home and school

*Tutorials can be found on the school website.*



# How you can help in school

---

## Can you ...

- ☐ Help in class?
- ☐ Listen to readers?
- ☐ Volunteer in our library?
- ☐ Help on a school trip?
- ☐ Share your expertise with the children?
- ☐ Mystery Reader

Please make sure you talk to your class rep. and/or teachers and attend one of our **new helper induction sessions.**





# Reading

---

The children will bring home two types of books:

**A reading practice book.** This will be at the correct phonic stage for your child. They should be able to read this fluently and independently.

**A sharing book.** Your child will not be able to read this on their own. This book is for you both to read and enjoy together.



# Year 1 holiday reading list

Here are some suggestions of great books that you could read over the holidays. Why not link this to the **Summer Reading Challenge at your local library** where you have to read six books?

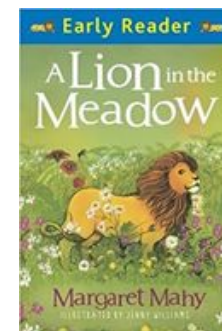
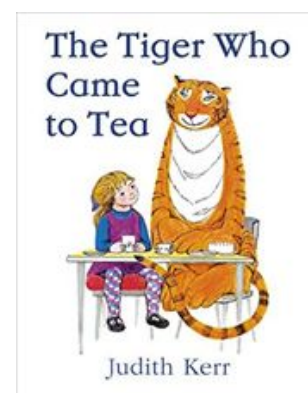
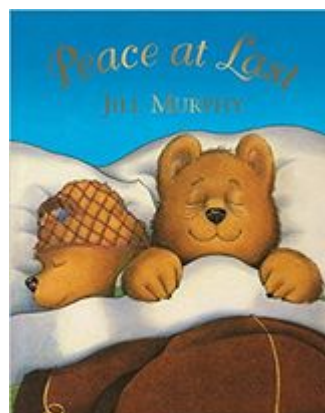
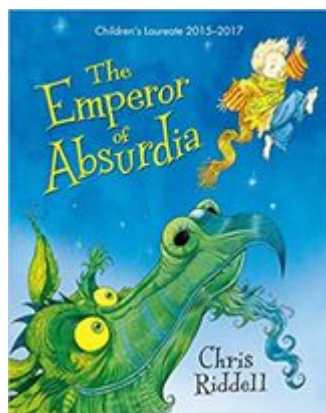
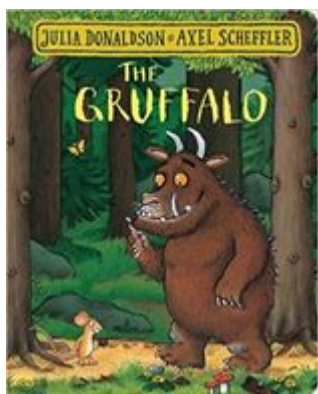
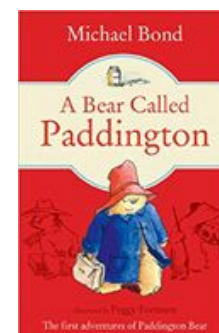
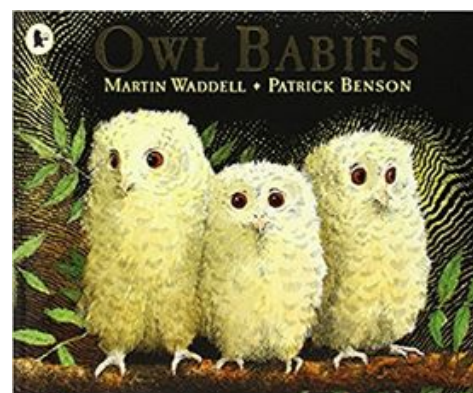

You can find more recommended books on: [www.schoolreadinglist.co.uk](http://www.schoolreadinglist.co.uk)



# Move Up Morning

---

- The children will spend the morning meeting their new teacher and getting to know their new classroom on Tuesday 19th July.





# Any questions?

---



# See you in September!

---

